

S-6200DD

Single needle direct drive straight lock stitcher
with thread trimmer

With the Direct Drive system, comfortable straight lock stitcher with thread trimmer for operators with low noise and vibration has been realized!

- Comfortable operation with low noise and vibration
- Excellent responsiveness for comfortable sewing
- Clean sewing without oil staining
- Economical sewing machine with low power consumption
- User-friendly operation panel
- Clean and fresh off-white color



Working with you for a better environment

www.brotherearth.com

S-6200DD Single needle direct drive straight lock stitcher with three

Comfortable sewing with stronger needle penetration force and accurate sewing of heavy materials

With the Direct Drive system and control box which is the same as S-7200C, the powerful motor outputs large amounts of torque so that strong needle penetration can be obtained. This allows accurate sewing of heavy materials and joints at overlapping parts of the fabric.

If the needle penetration resistance increases, such as sewing heavy materials and materials with joints, vibration control (intermittent impact) automatically increases the penetration force.

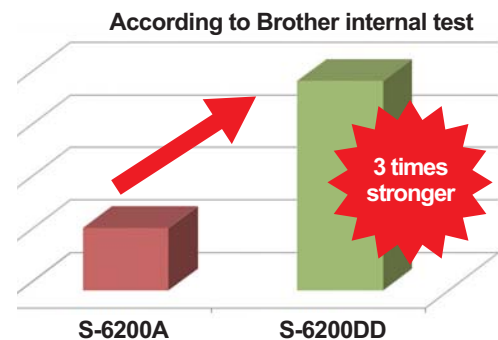

High Energy Saving

The Direct Drive system transmits the driving force directly to the mechanisms, realizing energy loss to minimum. Brother original motor is designed to fit the machine head perfectly, boosting high reliability. S-6200DD realizes high energy saving almost equivalent to the S-7200C.

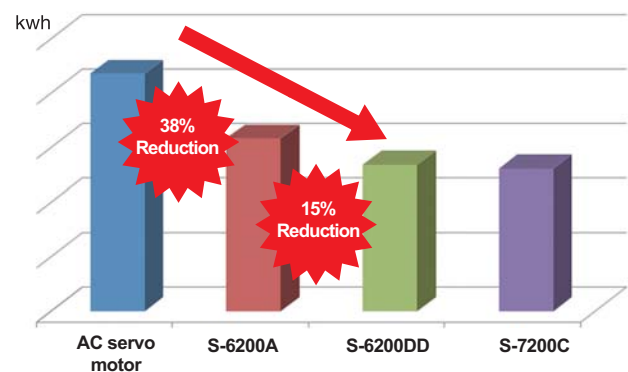

Prevention of needle breakage at reverse stitching

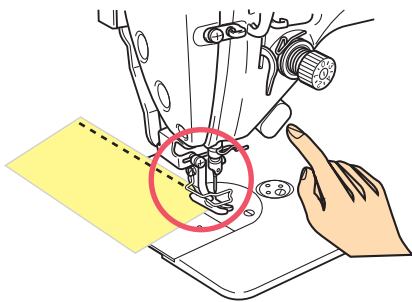

When reverse stitching is carried out with the quick back switch at a thick portion of the material such as an overlapping part, needle breakage may occur. With through analysis of its cause, the function preventing the needle breakage has been introduced. By setting the needle breakage preventing function to ON, the needle penetrates the material without the vibration, which lowers the possibility of the needle breakage. The Direct Drive mechanism lead to better responsiveness and less needle breaks.

Clean Sewing without Oil Staining

Supplying the minimum lubrication to the needle bar and thread take-up area, oil leakage from the needle bar can be prevented, realizing clean sewing. The Direct Drive system, having no residue from the V-belt can keep valued products clean.



Comfortable sewing with low noise and vibration

The sound and vibration during sewing have been reduced by the Direct Drive system, aligning the weight balance of the parts and having a preventive measure for sympathetic vibration. It brings comfortable sewing for operators who operate the machines for long hours.

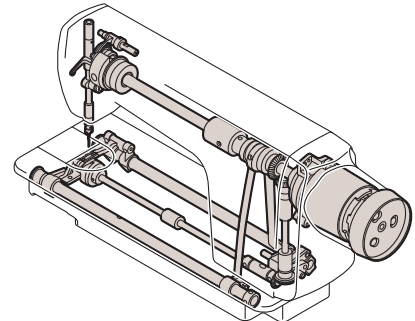

Comfortable sewing with Exceptional responsiveness and Direct Drive system

Exceptional responsiveness at starting and stopping of sewing

With the Direct Drive system, responsive speed by the operator's pedal operation has been reduced at starting and stopping of sewing. There is no time lag for the start, speed control, and stop of sewing. Since there is no V-belt the machine makes the needle bar stop highly accurate.

Time required to reach maximum sewing speed

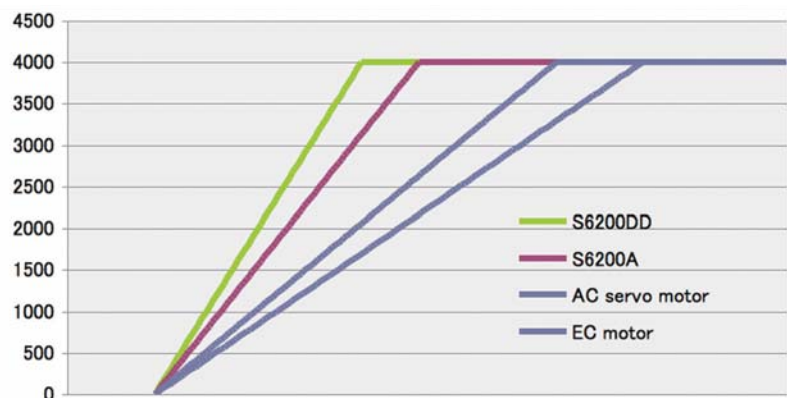

Sewing speed

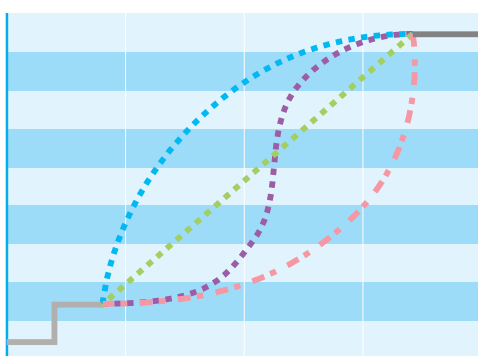

Tredle depression amount

The curve of the acceleration at sewing start can be selected by the operator's preference on the operation panel.

Environment-conscious

Brother has established its original "Brother Green Label" for the products, in conformity with ISO14021 and JISQ14021. The S-6200DD is certified as an environmentally-conscious sewing machine according to the "Brother Green Label" standard and is compliant with the RoHS*1 Directive.

The use of the restricted substances such as lead, cadmium, hexavalent chromium is absolutely within the regulation values. Brother has been providing all its products in accordance with the RoHS Directive for all market areas(excluding machine tools).

*1 The RoHS Directive(the restriction of the use of certain hazardous substances in electrical and electronic equipment) came into effect in the EU in July 2006.



S-6200DD-□0□

	Quick back	Thread wiper		Application
3	○	—	3	Light materials and Medium materials
4	○	○	5	Heavy materials



Thread wiper set(Option)
SB0605002

	-3	-5
Application	Light materials and Medium materials	Heavy materials
Max. sewing speed	5,000sti/min	4,000sti/min
Max. stitch length	4.2mm	5.0mm
Thread take-up stroke	57.9mm	62mm
Needle bar stroke	31mm	35mm
Height of feed dog	0.8mm	1.2mm
Height of knee lifter	13mm	
Bed size	570 x 350 x 285mm	
Weight	37.5kg	
Arm pocket size	Width 266.5mm, Height 27mm	
Needle(DBx1 • DBx5)	#11-#18	#19-#22
Lubrication oil	High-speed spindle oil	
Motor	AC servo motor(4-pole,450W)	
Power	100V-110V, 200-230V, 380-400V 50/60Hz	

When sewing at a sewing speed of 4,000sti/min and above, set the stitch length to 4.2mm and under.



G10 Panel



G50 Panel

	Start backtack	End backtack	Continuous backtack	Fixed stitch	Name label	Pleat presser sewing	Program sewing	Lower thread counter
G10 Panel	○	○	○	—	—	—	—	—
G50 Panel	○	○	○	○	○	○	○	○

Product specifications are subject to change for improvement without notice. Please read instruction manual before using the machine for safety operation.



BROTHER INDUSTRIES, LTD.

5, Kitajizoyama, Noda-cho, Kariya-shi, Aichi 448-0803, Japan.
hone: 81-566-95-0088 Fax: 81-566-25-3721 <http://www.brother.com/>

CHINA	BROTHER MACHINERY SHANGHAI LTD. http://www.brother.cn/	+86-21-3135-33
HONG KONG	BROTHER INTERNATIONAL (HK) LTD. http://www.brother.com.hk/	+852-3589-90
ASIA	BROTHER INTERNATIONAL SINGAPORE PTE LTD. http://www.brother.com.sg/	+65-6536-88
EUROPE AFRICA,MIDDLE EAST	BROTHER INTERNATIONALE INDUSTRIEMASCHINEN G. m. b. H. http://www.brother-ism.com/	+49-2822-60
AMERICAS	BROTHER INTERNATIONAL CORPORATION http://www.brother-usa.com/	+1-908-704-17